



**1**

516

497

456

439

PAR 5

HCP 9

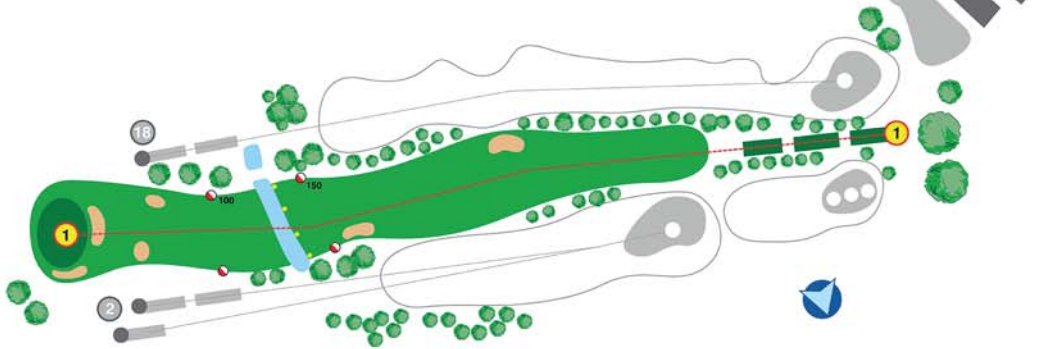

**2**

338

309

291

278

PAR 4

HCP 13

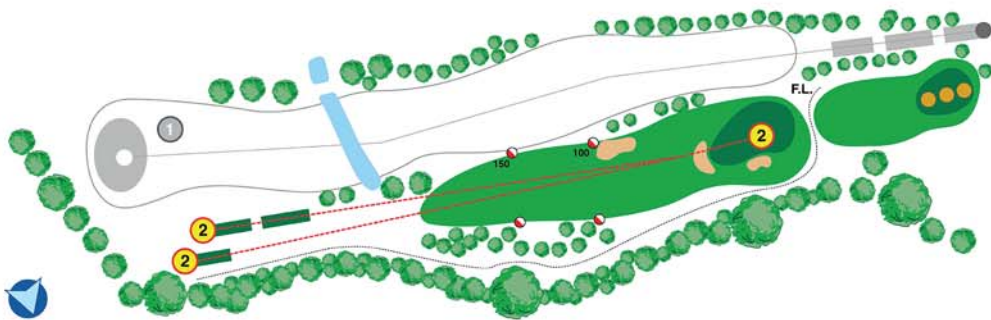

**3**

319

307

290

280

PAR 4

HCP 11

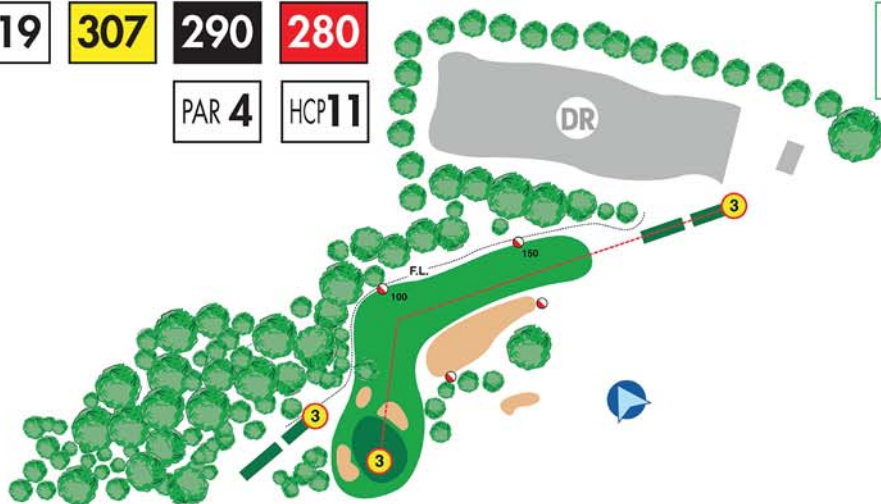



**4**

373

362

352

341

PAR 4 HCP 3



**5**

134 123 113 102 PAR 3 HCP 15

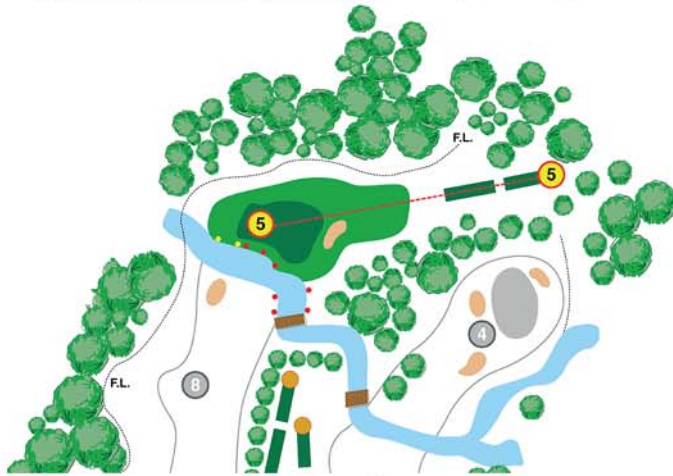

**6**

365 321 302 277 PAR 4 HCP 7

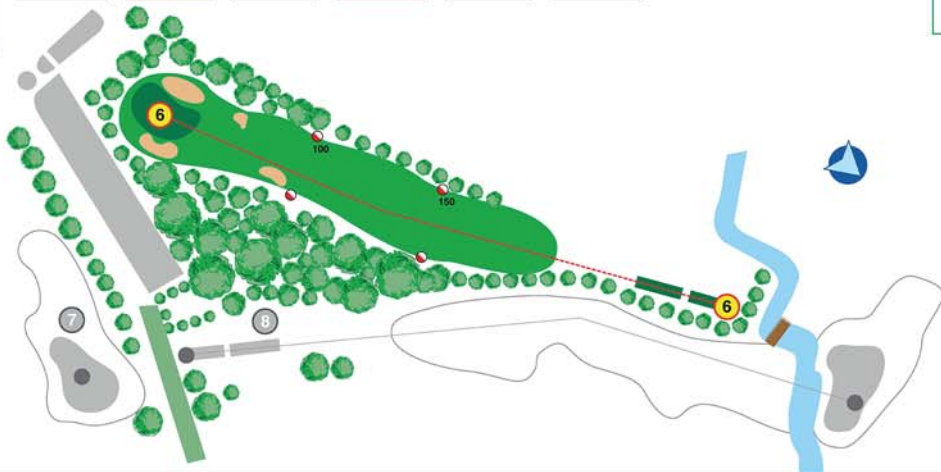





**7**

184

172

152

139

PAR 3

HCP 5

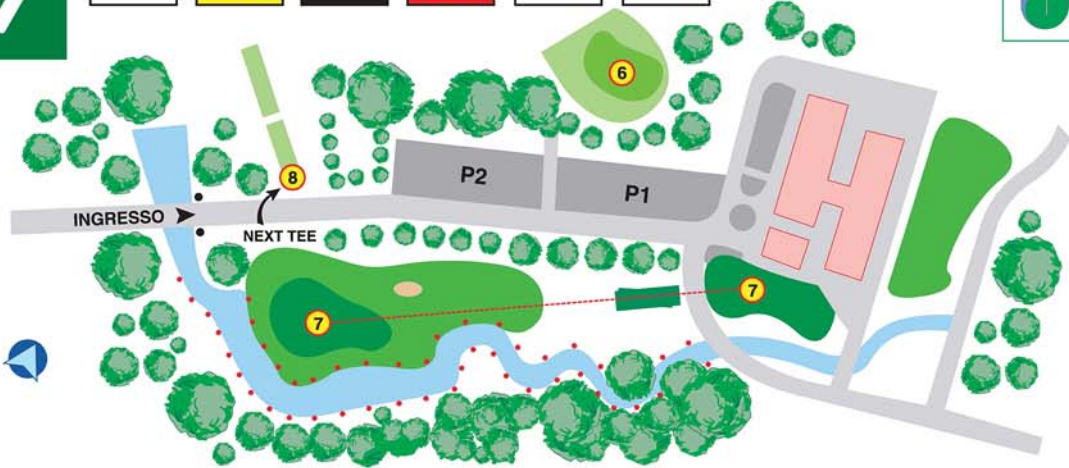

**8**

397

387

367

357

PAR 4

HCP 1

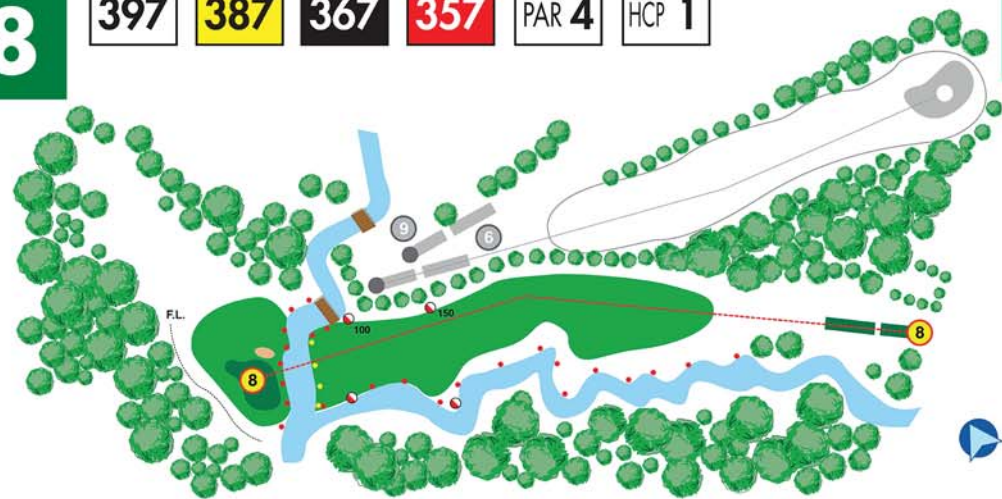

**9**

461

442

423

412

PAR 5

HCP 17

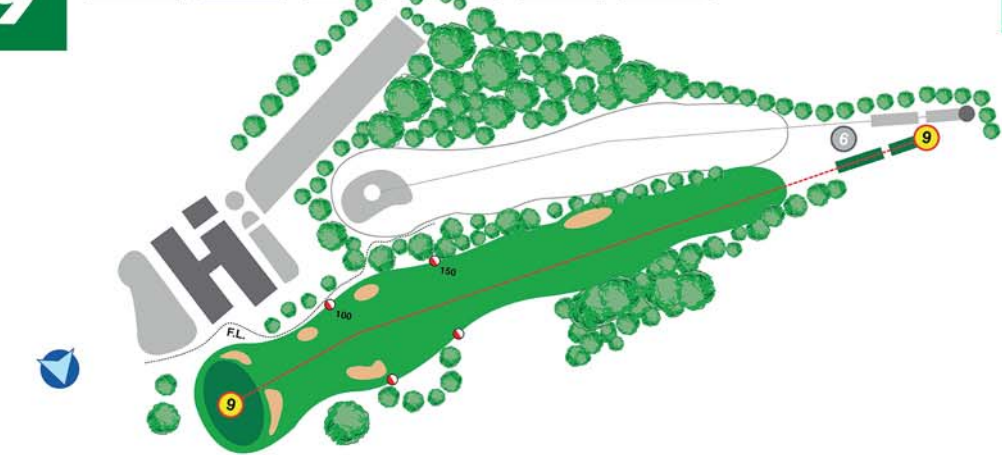



**10**

424

411

376

331

PAR 5

HCP 12

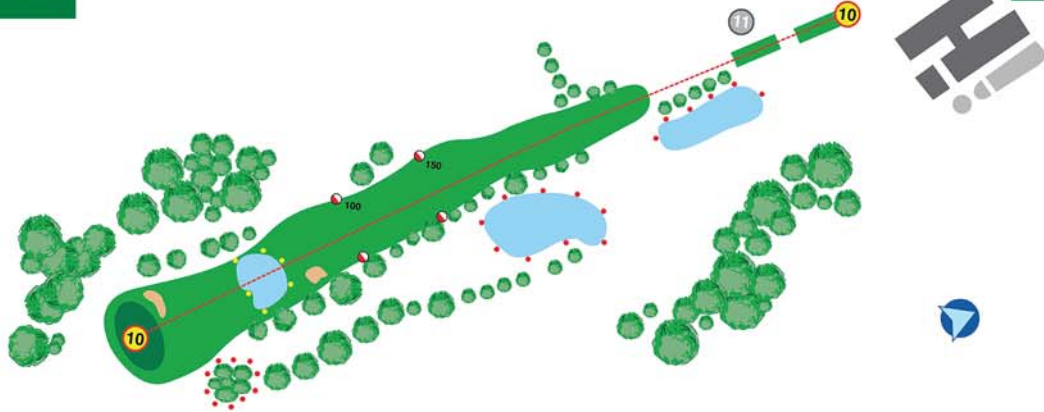

**11**

379

364

346

326

PAR 4

HCP 6

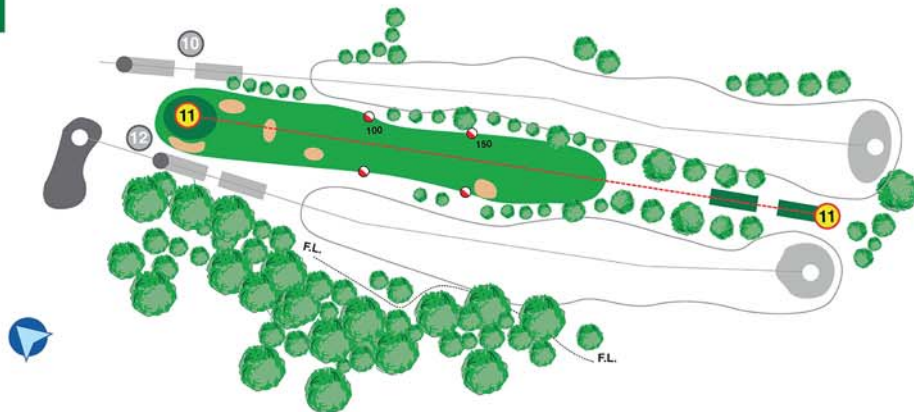

**12**

409

391

361

347

PAR 5

HCP 14

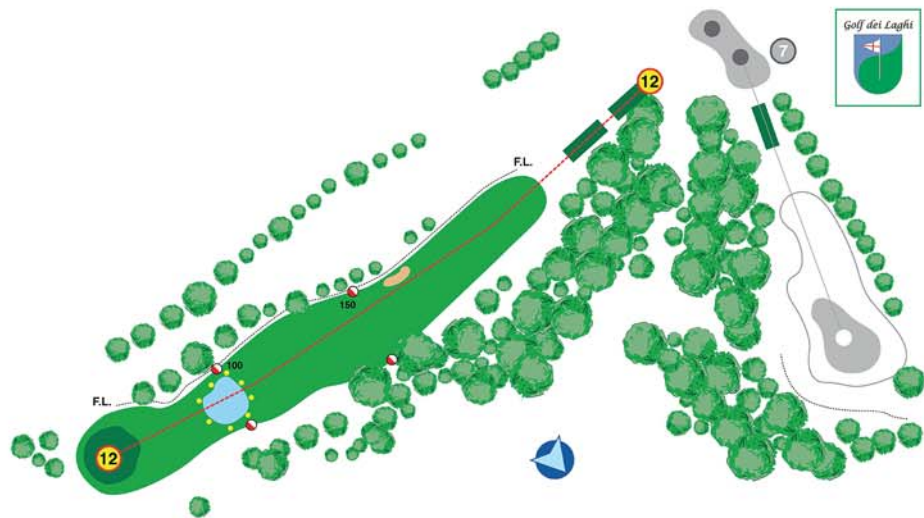





**13**

150

140

129

122

PAR 3

HCP 10

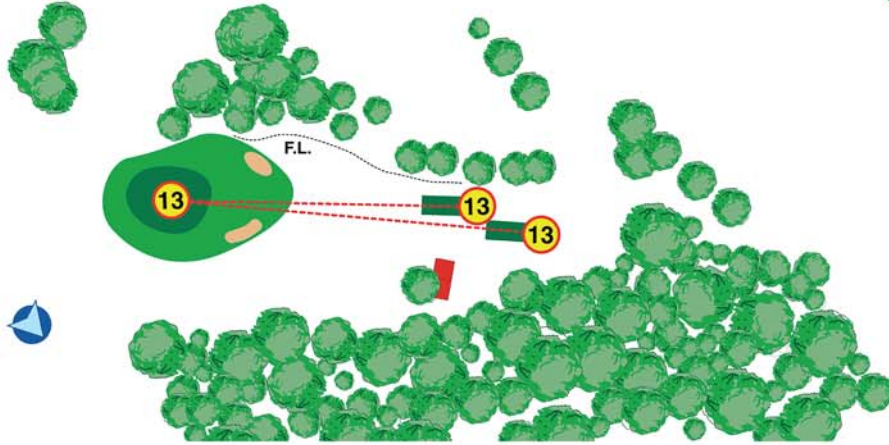

**14**

263

245

230

221

PAR 4

HCP 18

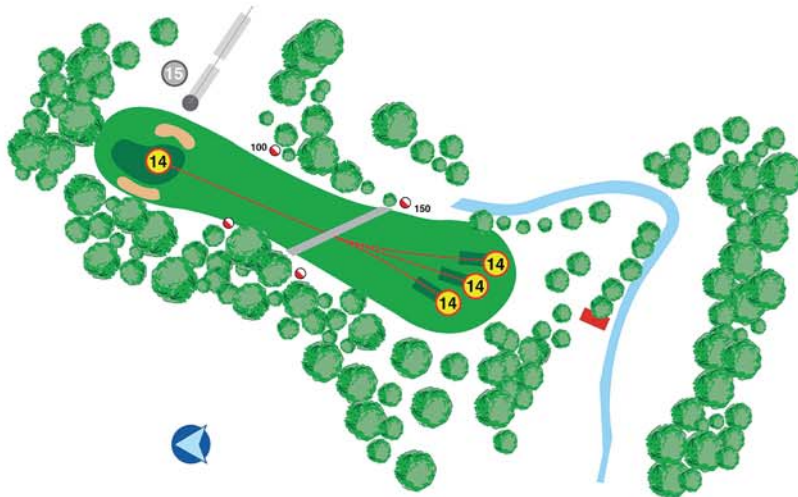

**15**

395

378

361

348

PAR 4

HCP 4





**16**

392

378

360

346

PAR 4 HCP 2



**17**

204

185

147

133

PAR 3

HCP 8

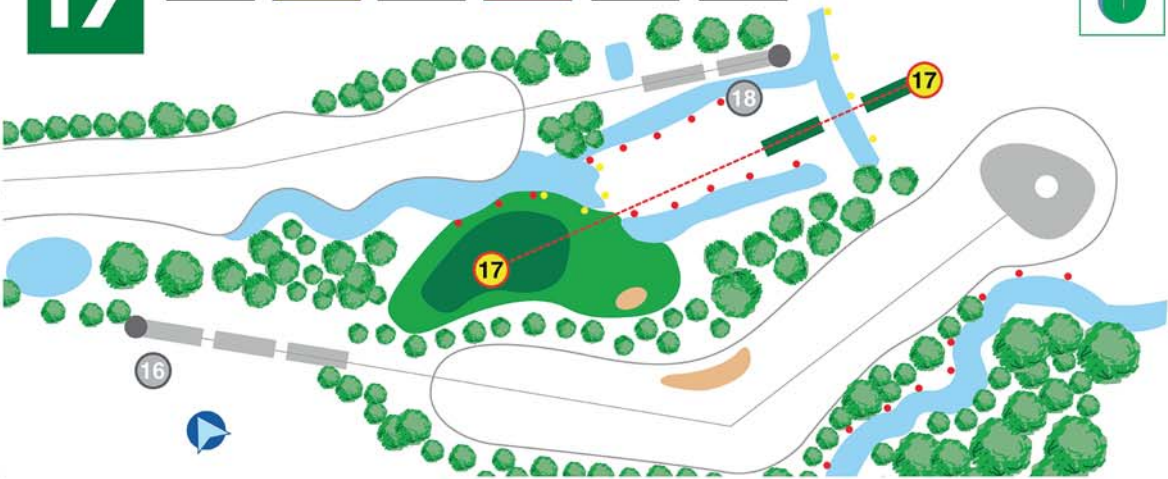

**18**

434

415

393

381

PAR 5

HCP 16

